

Poultry Development - City of Tshwane (Ward 49) - Farm Grootvlei 272 JR Portion 65 - Gauteng Province

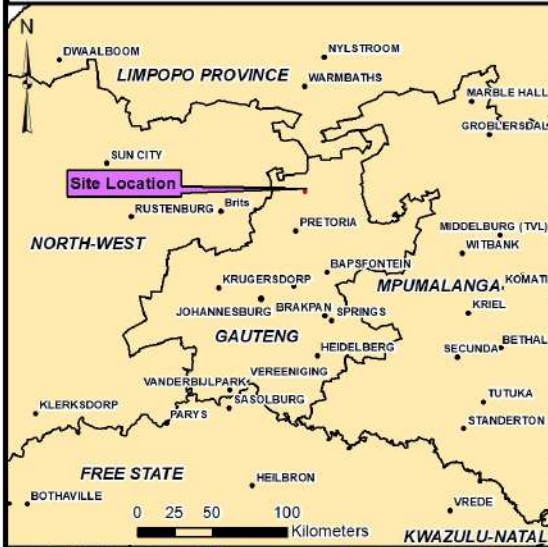
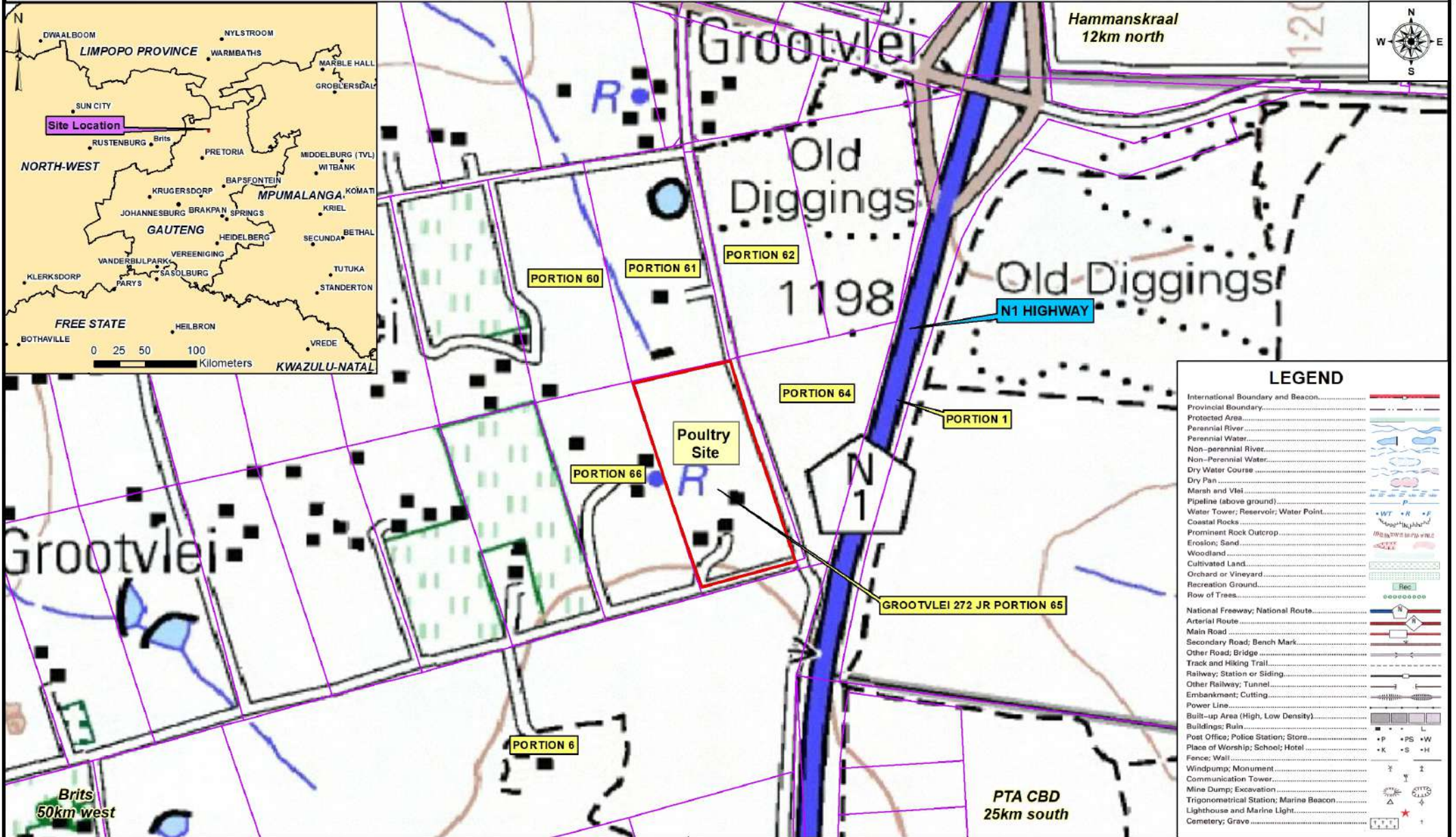

LEGEND	
International Boundary and Beacon	
Provincial Boundary	
Protected Area	
Perennial River	
Perennial Water	
Non-perennial River	
Non-Perennial Water	
Dry Water Course	
Dry Pan	
Marsh and Vlei	
Pipeline (above ground)	
Water Tower; Reservoir; Water Point	
Coastal Rocks	
Prominent Rock Outcrop	
Erosion; Sand	
Woodland	
Cultivated Land	
Orchard or Vineyard	
Recreation Ground	
Row of Trees	
National Freeway; National Route	
Arterial Route	
Main Road	
Secondary Road; Bench Mark	
Other Road; Bridge	
Track and Hiking Trail	
Railway; Station or Siding	
Other Railway; Tunnel	
Embankment; Cutting	
Power Line	
Built-up Area (High, Low Density)	
Buildings; Ruin	
Post Office; Police Station; Store	
Place of Worship; School; Hotel	
Fence; Wall	
Windpump; Monument	
Communication Tower	
Mine Dump; Excavation	
Trigonometrical Station; Marine Beacon	
Lighthouse and Marine Light	
Cemetery; Grave	

Legend

- Poultry Development
- Farm Portions

LOCALITY MAP

0 162.5 325 650 Meters

Date: 10 March 2025

General Site Location
 25°30'36.74"S & 28°16'59.46"E
 SG Codes: T0JR00000000027200065

SELAHLE
 CONSULTANCY & PROJECTS

Cell No.: 079 614 8298
 Fax: 086 552 0171
 Email: shonie@scprojects.co.za
 Website: www.scprojects.co.za

ANDRE ZANOLI
 t/a
**GIS MAPPING &
 ENVIRO-MINING**

Contact Person: Andre Zanol
 Contact Number: 072 601 2432
 Date: 10 March 2025